

URBAN

SJS205

FLOORSTANDING BATH SHOWER
MIXER TAP

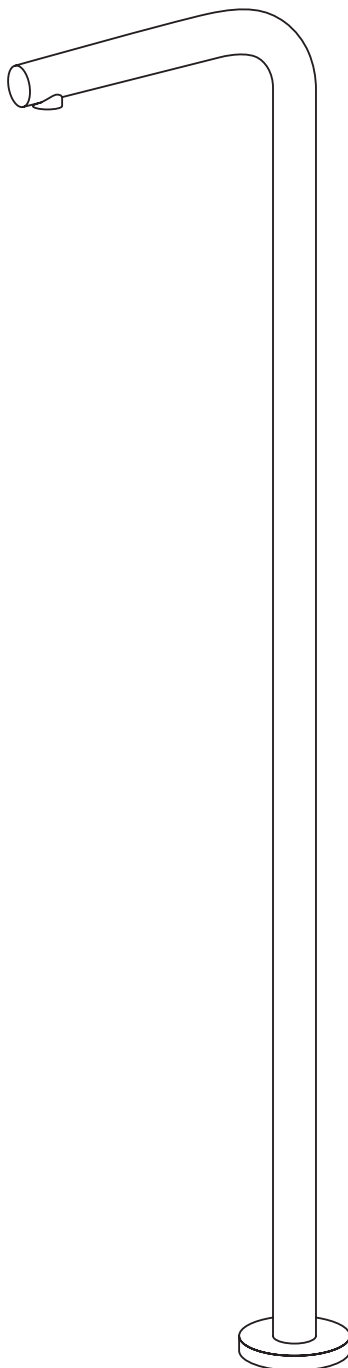

EN
INSTALLATION
AND CARE GUIDE

Please retain for future reference

LUSO

INTRODUCTION

Thank you for purchasing the Urban Floorstanding Bath Shower Mixer Tap.

Please read this guide carefully before installing, using and cleaning this product, and retain it for future reference. Please also note that this mixer tap has been fully tested before being dispatched, which may mean there is water residue on some of the parts.

If you have any queries in relation to this product or guide, please contact our Customer Service team on 020 3370 4057.

PRODUCT KIT

- A** Spout
- B** Baseplate
- C** Connector
- D** Valve
- E** Allen Key

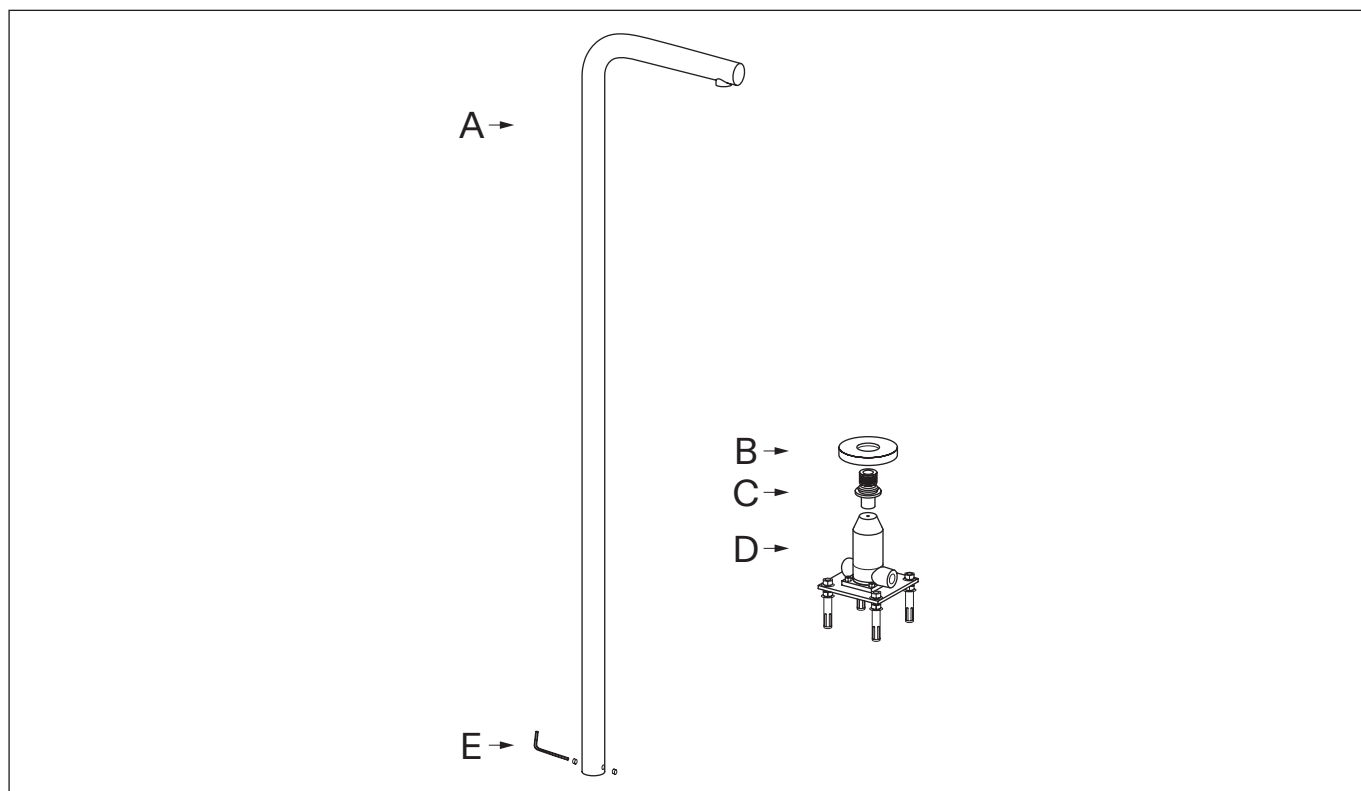

INSTALLATION STEPS

Before installation, please note that this tap is designed for floor mounting only, and we recommend that it is installed by a fully qualified plumber. It is suitable for use on all boiler systems including pumped, gravity and combination boilers to a maximum pressure of 5 bar - pressure above this may require the fitting of reducer valves. Please also note that failure to flush your plumbing system as part of the installation process will void the product guarantee. In addition, you must fully test the product before tiling and/or plastering, etc as Lusso will not be held responsible for any costs involved in the removal of the tap if you find there is a fault.

- 1 Carefully check the dimension drawing and mark the position for the tap before making an opening in the floor.
- 2 Install the spout valve into the floor and connect the water feed. Please ensure that the valve is screwed tightly into position and there is no movement.
- 3 Fix the valve into place using the provided screws, and open the main valve to check for leakages before sealing the slot.
- 4 Using PTFE tape on the threaded part, connect the spout and tighten into position with the provided allen key. Test the tap for leaks.

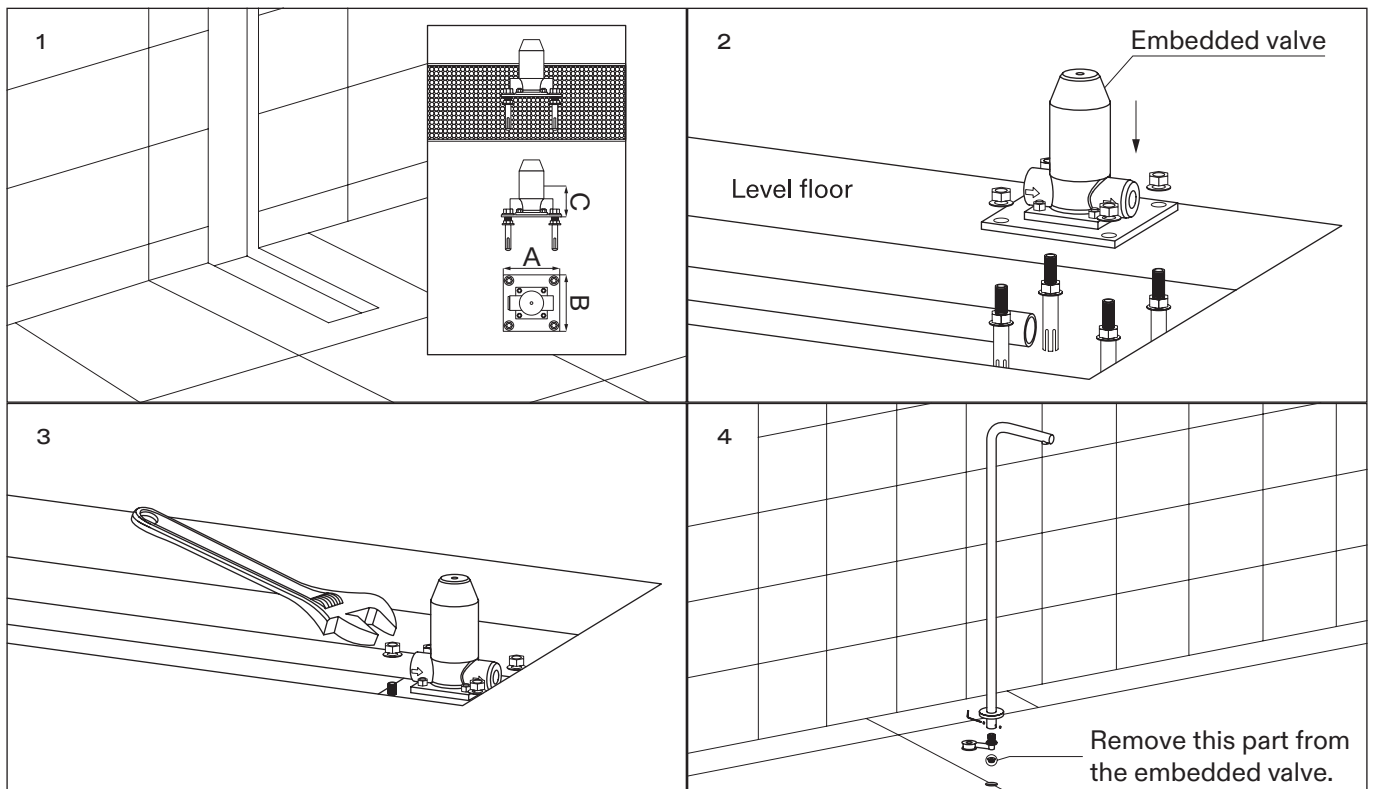

CARE INSTRUCTIONS

To clean and maintain the flawless finish of this product, please follow the below instructions. Improper maintenance will void your product guarantee.

✓ Clean with a damp cloth.

✗ Do not use acidic cleansers.

✗ Do not use abrasive cleansers or cloths.

Go to Lusso.com to activate your guarantee.

LUSO

Customer Care: 020 3370 4057

International: +44 20 3370 4057