

✓ TOOLS REQUIRED - HOLE SAW

LUSSO
STONE

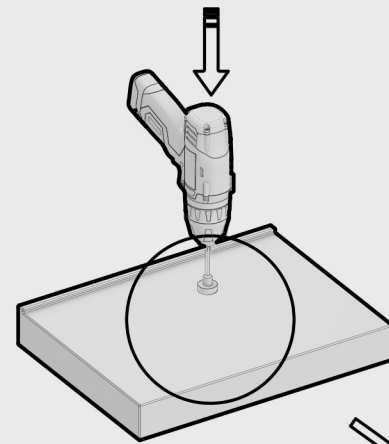

Our stone resin material is easily drilled using a regular hole saw and regular drill piece.

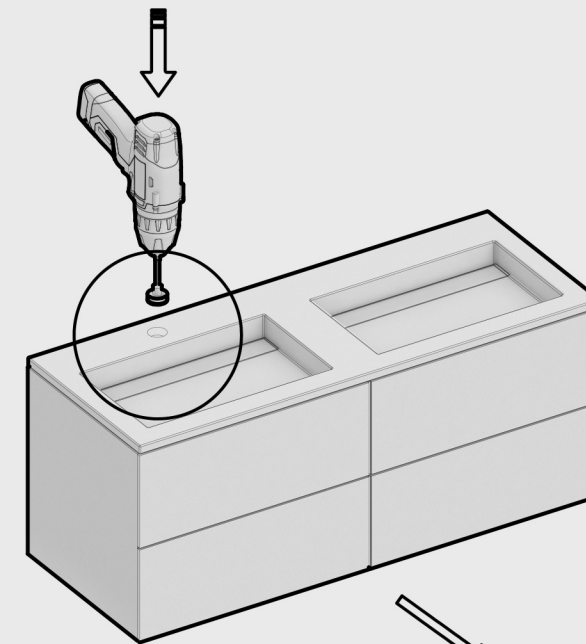

All our basins and countertops are supplied undrilled to give you the option to position the basin where you desire or to give you the freedom of using wall mounted or deck mounted taps.

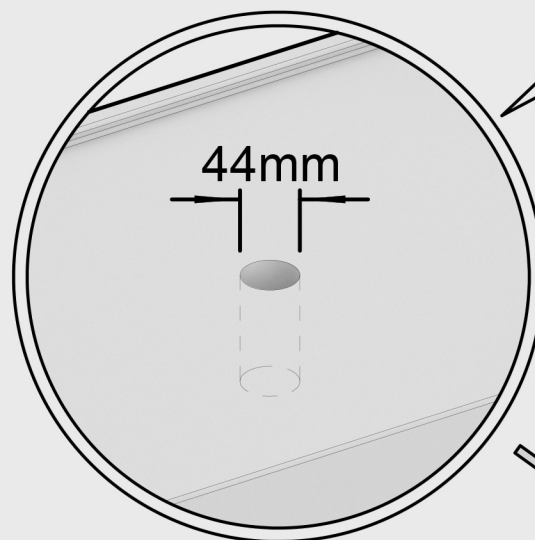

Using the correct hole sizes displayed, the hole is easily drilled.

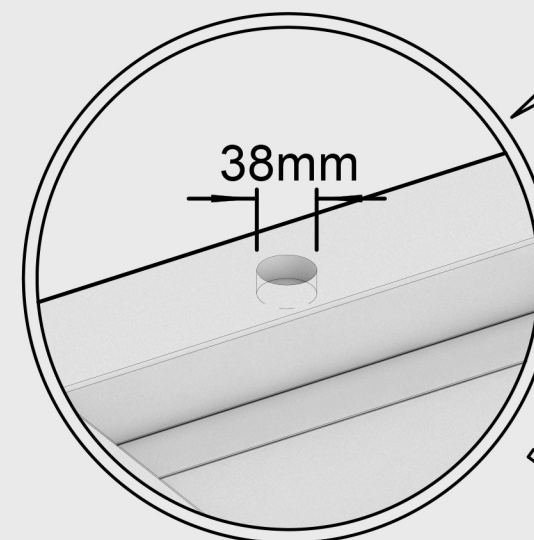

Our material is solid all the way through with no layering to cause weakness, making it ideal for bespoke drilling.

