

CUBOX

SN3090

FRAMELESS BATHROOM
SHOWER NICHE 300MM

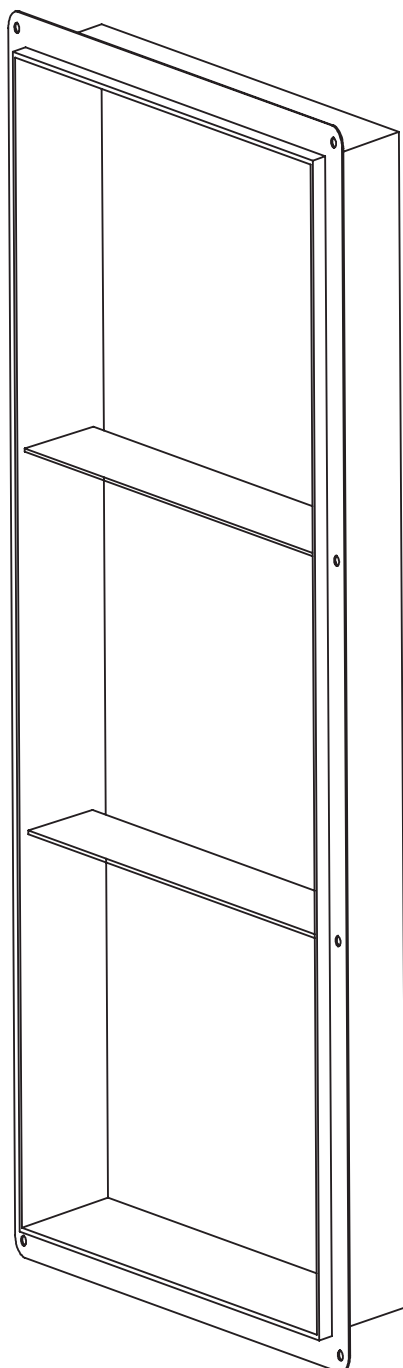

EN
INSTALLATION
AND CARE GUIDE

Please retain for future reference

LUSO

INTRODUCTION

Thank you for purchasing the Cubox Frameless Bathroom Shower Niche 300mm.

Please read this guide carefully before installing, using and cleaning this product, and retain it for future reference.

If you have any queries in relation to this product or guide, please contact our Customer Service team on 020 3370 4057.

PRODUCT KIT

A Shower Niche

B Screws (x8)

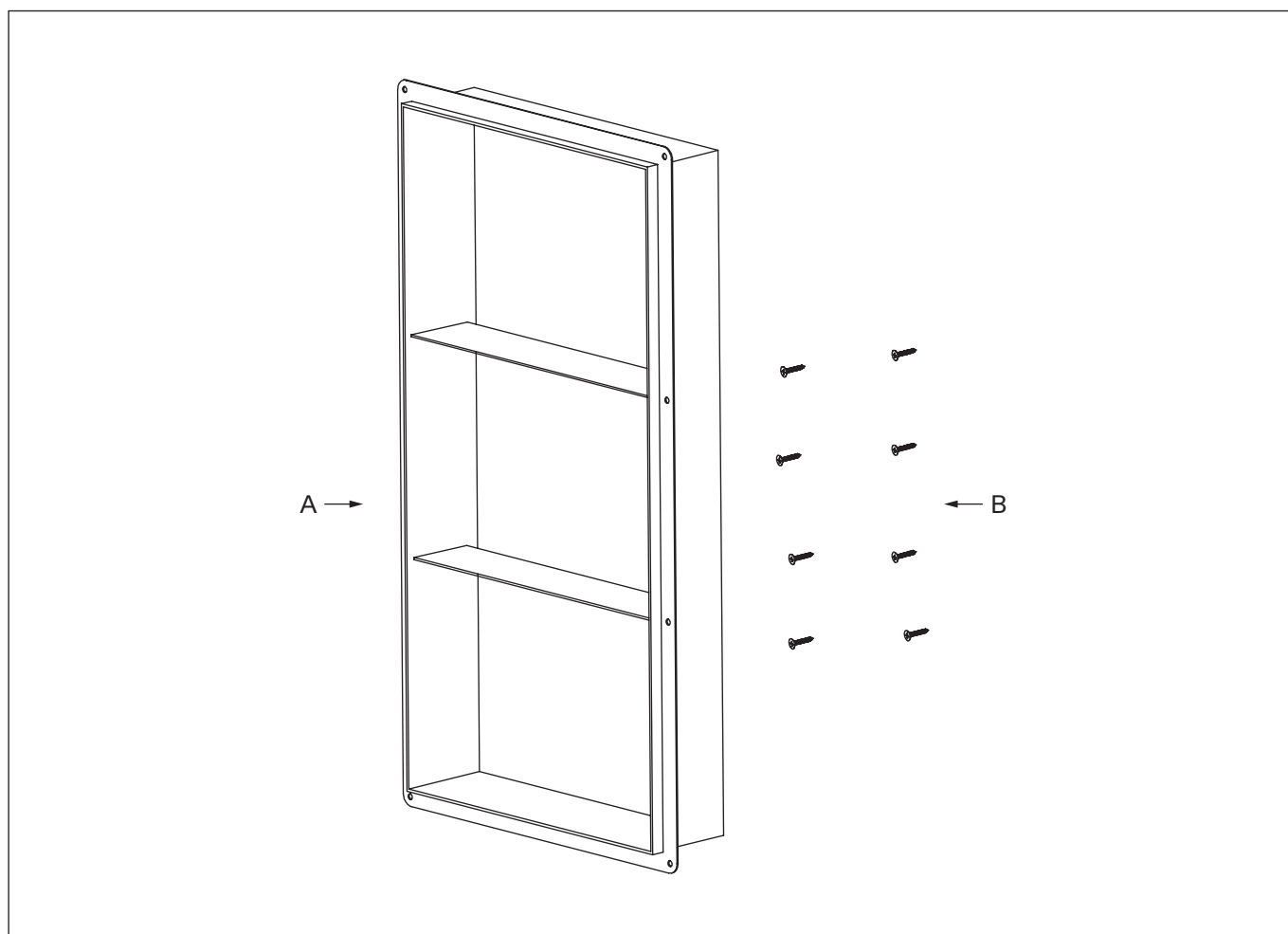

INSTALLATION STEPS

Before installation, please thoroughly check all parts and components for any faults as the product guarantee is not valid for installed items with pre-existing defects.

For best results, we recommend that this shower niche is installed by a professional tradesperson in compliance with relevant building regulations.

- 1 After preparing a 905mm high, 305mm wide and 80mm deep recess in the wall, carefully place the niche into the recess.
- 2 Next, use a screwdriver and the provided screws to secure the niche into position.
- 3 Tile the surrounding area using tiles with a maximum thickness of 12mm, and ensure that all joints between the niche and the wall are waterproofed.
- 4 After tiling, check and confirm that the niche is well secured to the wall, as shown in figure 4.

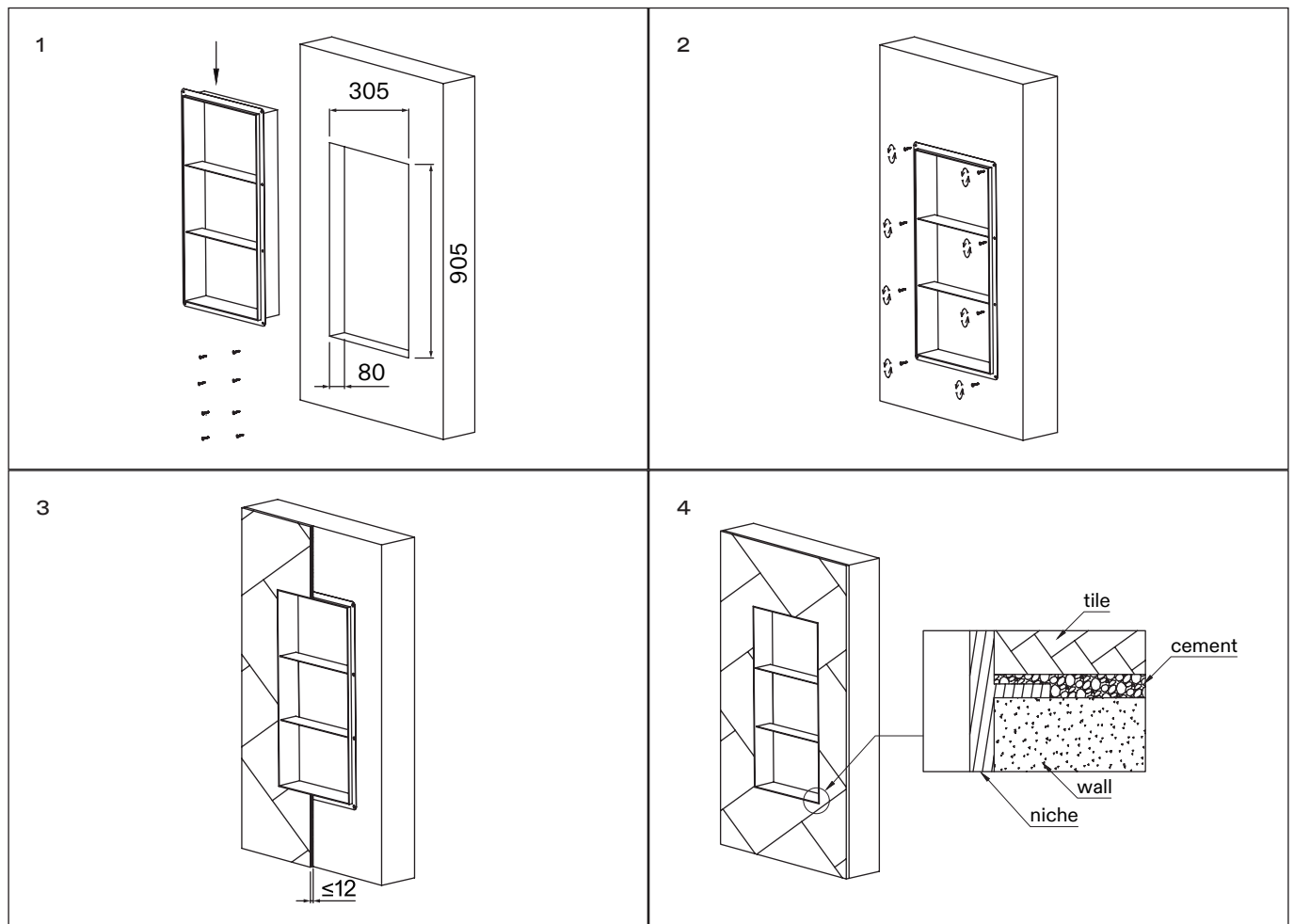

CARE INSTRUCTIONS

To clean and maintain the flawless finish of this product, please follow the below instructions. Improper maintenance will void your product guarantee.

✓ Remove surface marks using a neutral cleanser without coarse grained powder.

✗ Do not use acidic cleansers.

✗ Do not use abrasive cleansers or cloths.

Go to Lusso.com to activate your guarantee.

LUSO

Customer Care: 020 3370 4057

International: +44 20 3370 4057